

Donation Lot No 1988

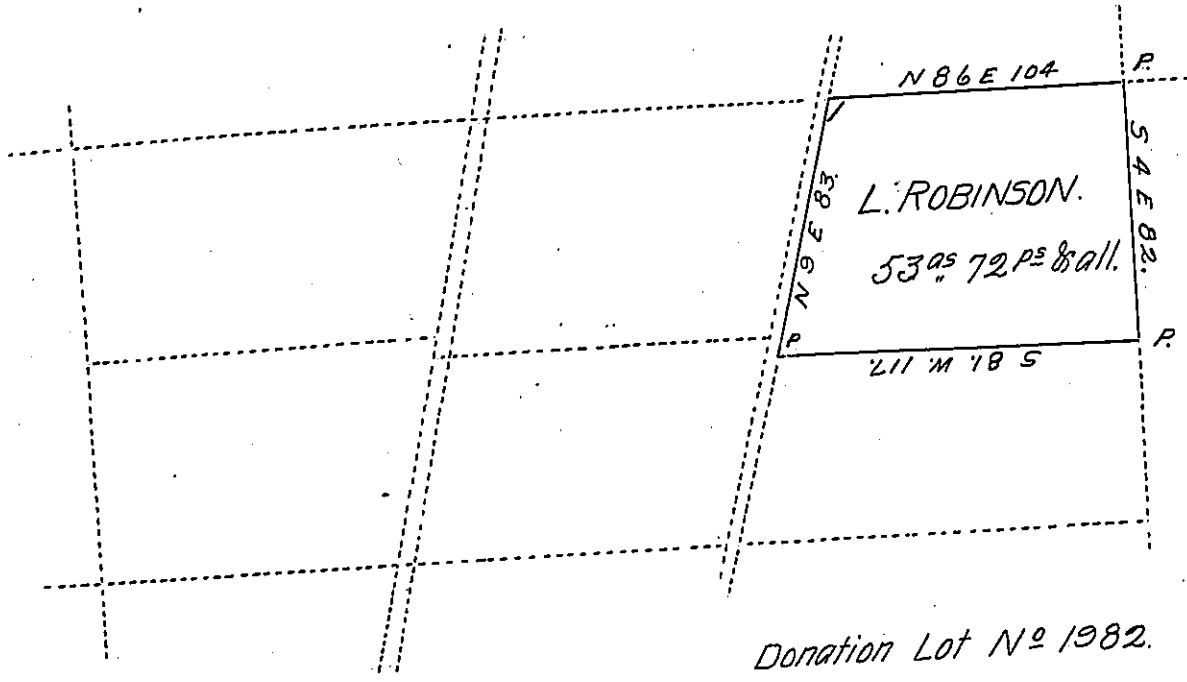

Donation Lot No 1982.

A draught of a part of Donation tract No 1989 in the tenth Donation District Amity Township Erie County Surveyed September 13. 1864 for Lyman Robinson by virtue of his actual settlement residence & improvement Containing Fifty three acres & 72 perches & allowance of six per cent for Roads & C.

W^m Benson

County Surveyor

To Hon. James P. Barr }
 Surveyor General }

IN TESTIMONY that the above is a copy of the original remaining on file in the Department of Internal Affairs of Pennsylvania, made conformably to an Act of Assembly approved the 16th day of February, 1833, I have hereunto set my Hand and caused the Seal of said Department to be affixed at Harrisburg, this thirteenth day of September 1906.

Loose P. Brown
 Secretary of Internal Affairs.